

This drawing is the property of VAT.

Revision

Customer number

D Glenair plug
6-pin

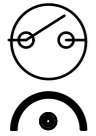

D Glenair plug
6-pin

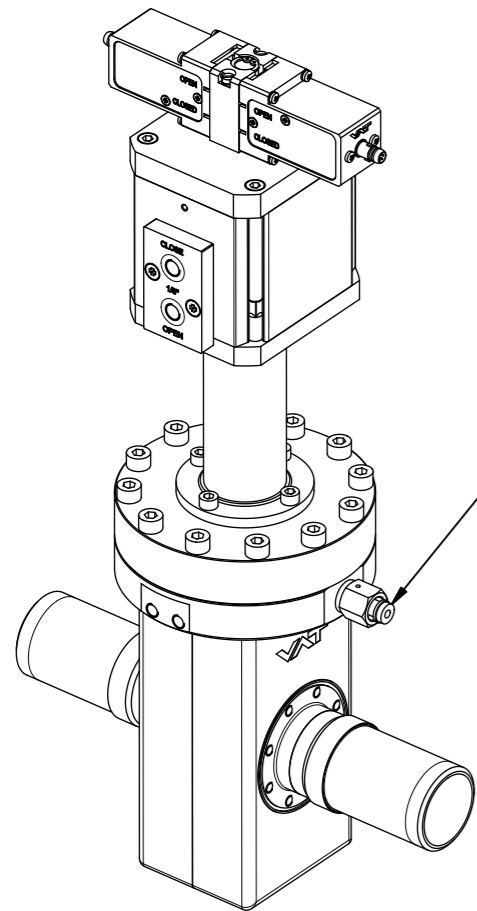

port VCR 1/4" for intermediate pumping. (between two bellows and between double wall body)
- port SS-4-VCR-3
- nut SS-4-VCR-1

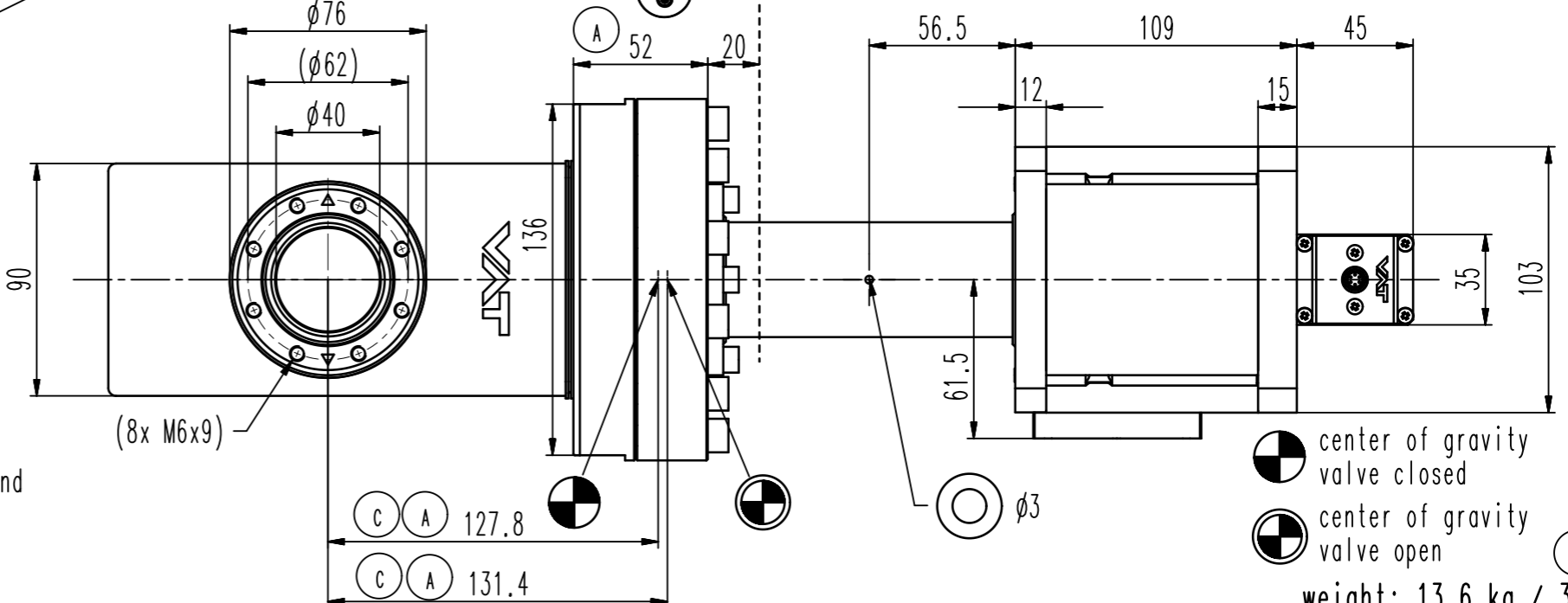
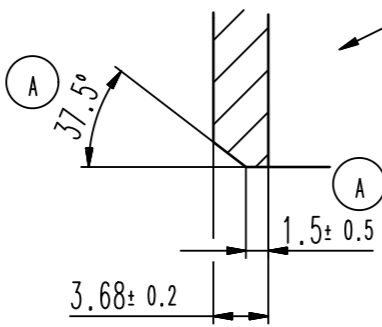
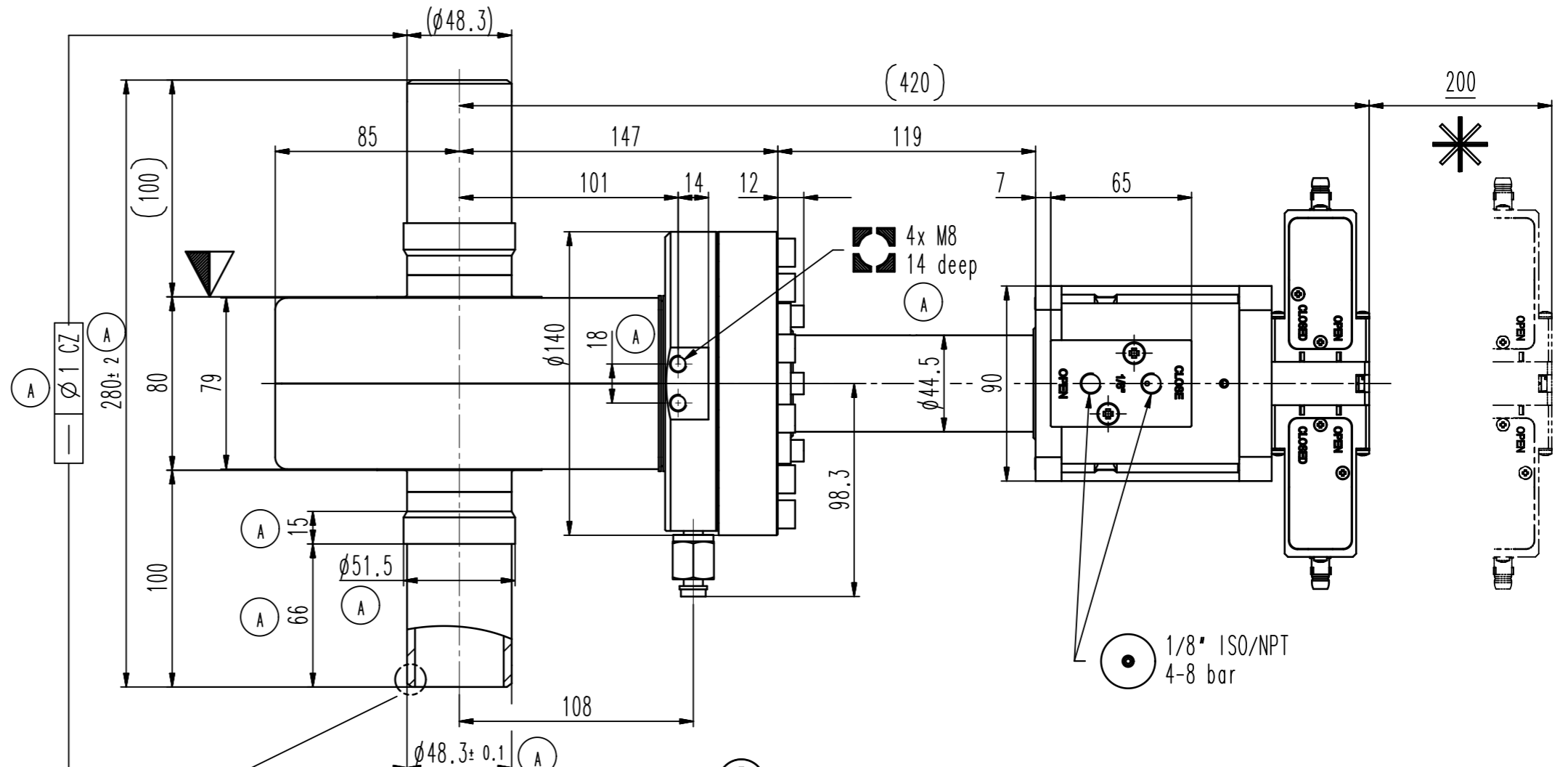

center of gravity valve closed
center of gravity valve open

weight: 13.6 kg / 30.0 lbs

- Seat side
- Comp. air connection
- Electrical connection
- Leak detection port
- Mech. pos. indication
- Position indicator
- Required for dismantling
- Emergency actuation
- For attachment
- Bake-out area
- Differential pumping port

All-metal gate valve
product: valve typ ITER 1; flange A+B; ; weld stub flange: Schedule No. 40S;

VAT Vakuumentile AG
CH-9469 Haag, Switzerland
Tel ++41 81 7716161 Fax ++41 81 7714830

Rev.-Date: 12.05.20
Visa: MAT

Series	481	Ordering No.	48132-RE24-AR11
Projection E		DN	40
Flange			R
Dimensional Drawing			749939
Rev.			D