

This drawing is the property of VAT.

Revision

Customer number

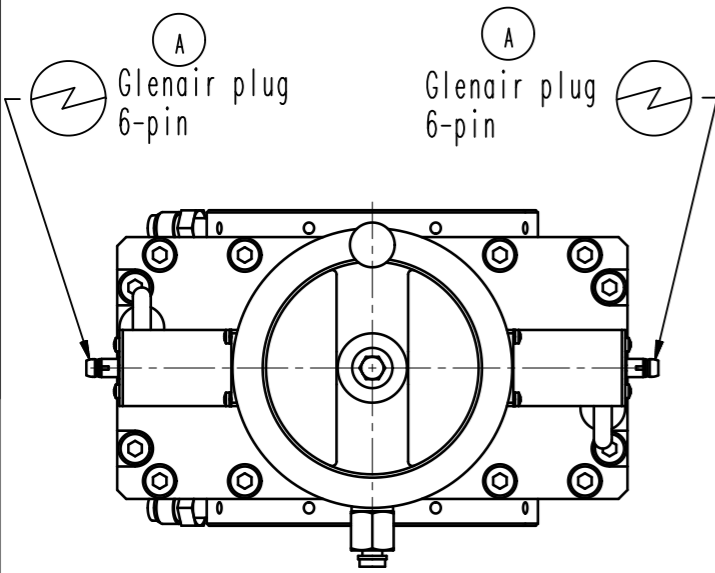

port VCR 1/4" for intermediate pumping. (between two seals)
 - port SS-4-VCR-3
 - nut SS-4-VCR-4

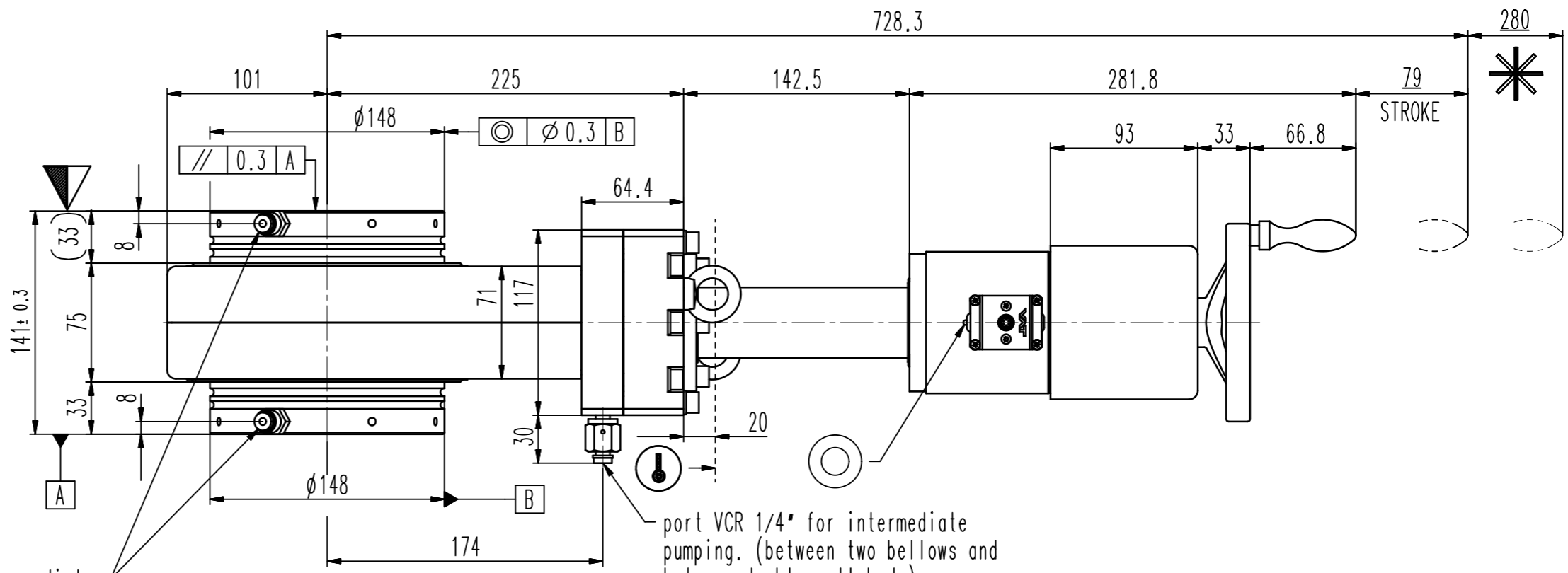

port VCR 1/4" for intermediate pumping. (between two bellows and between double wall body)
 - port SS-4-VCR-3
 - nut SS-4-VCR-1

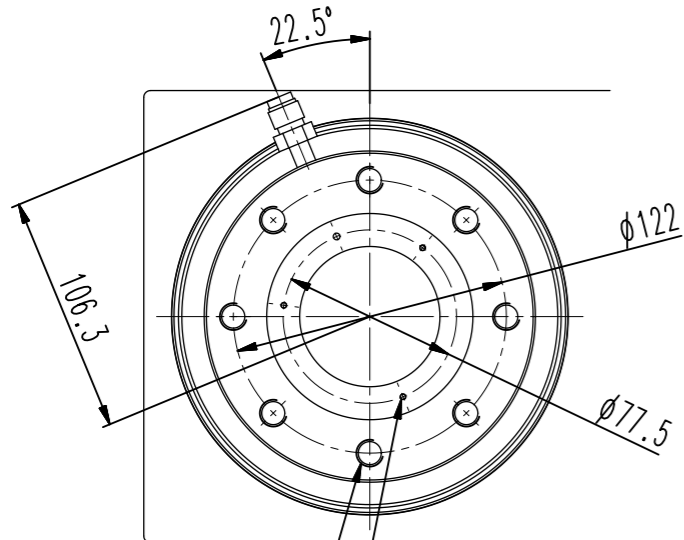

8x M12, 24 deep
 3x Ø2.5H7, 8 deep

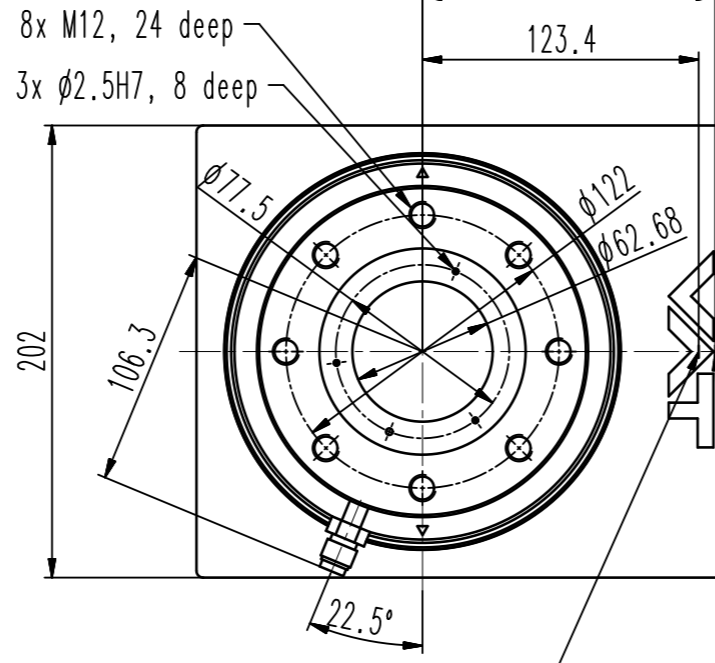

8x M12, 24 deep
 3x Ø2.5H7, 8 deep

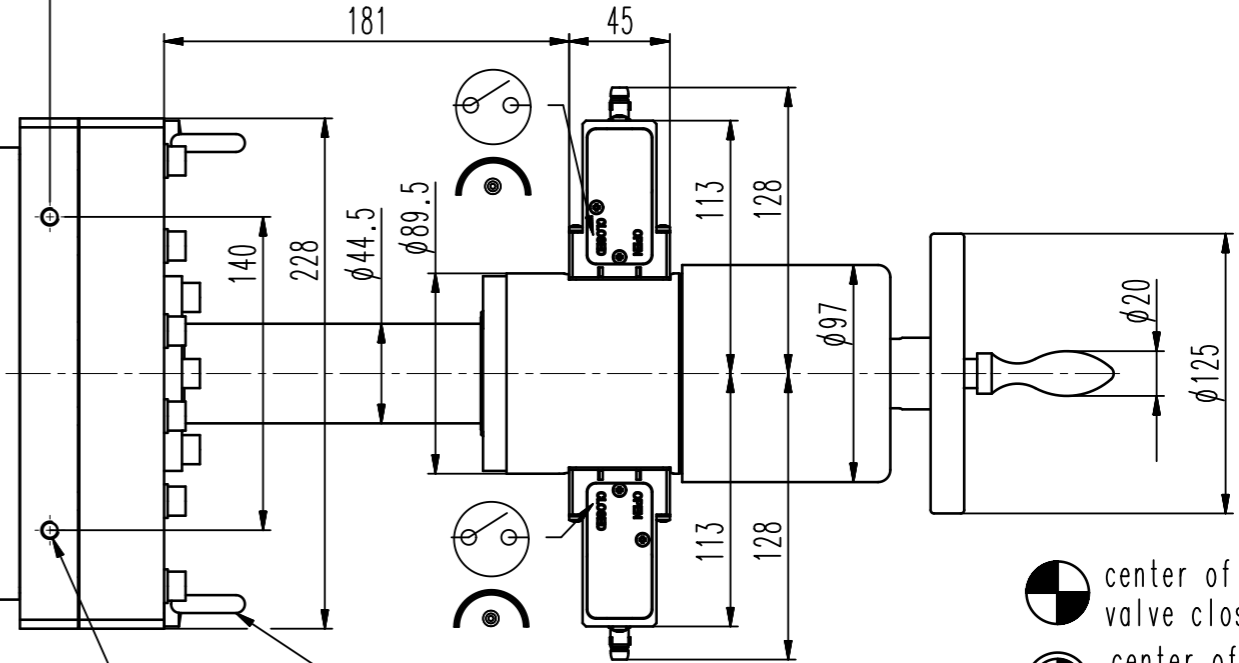

center of gravity valve closed
 center of gravity valve open

weight 34.3 kg / 75.6 lbs

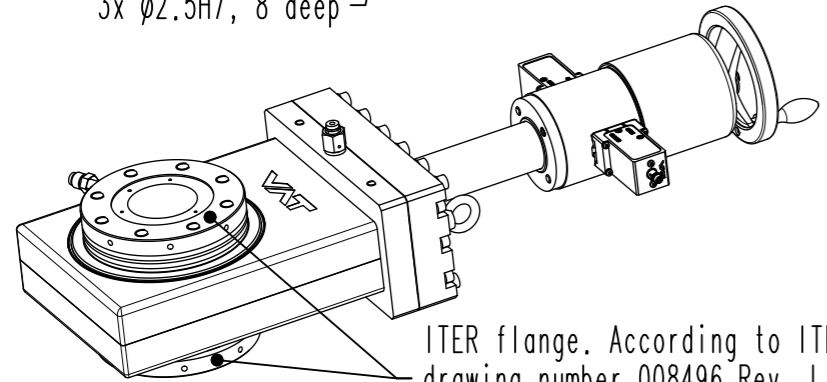

ITER flange. According to ITER drawing number 008496 Rev. L

- ▼ Seat side
- ⊙ Comp. air connection
- ⊙ Electrical connection
- ⊙ Leak detection port
- ⊙ Mech. pos. indication
- ⊙ Position indicator
- ⊙ Required for dismantling
- ⊙ Emergency actuation
- ⊙ For attachment
- ⊙ Bake-out area
- ⊙ Differential pumping port

All-metal gate valve

product: valve typ ITER 1; flange A+B; ; type ITER;



VAT Vakuumventile AG
 CH-9469 Haag, Switzerland
 Tel ++41 81 7716161 Fax ++41 81 7714830

Rev.-Date: 14.05.20
 Visa: MAT

Series	482	Ordering No.	48236-XE05-ATU1
Projection E	DN	Flange	X
	63		
Dimensional Drawing	940670	Rev.	A