

- ▼ Seat side
- Comp. air connection
- Electrical connection
- Leak detection port
- Mech. pos. indication
- Position indicator
- \* Required for dismantling
- Emergency actuation
- For attachment
- Bake-out area
- Differential pumping port

### UHV angle valve

product: valve type ITER 22;



VAT Vakuumventile AG

CH-9469 Haag, Switzerland  
Tel ++41 81 7716161 Fax ++41 81 7714830

Rev.-Date: 08.10.18

Visa: GOED

Series

284

Ordering No.

28428-GE21-CVK1

Projection E

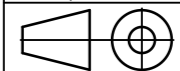

DN

25

Flange

CF-R

Dimensional  
Drawing

956348

Rev.